

1911

Owner's Manual



WARNING:
YOU MUST READ AND FOLLOW THE
WARNINGS AND INSTRUCTIONS
CONTAINED IN THIS MANUAL BEFORE
USING THIS FIREARM

STANDARD MANUFACTURING COMPANY
100 BURRITT STREET, P.O. BOX 1692
NEW BRITAIN, CONNECTICUT 06053
PHONE: 860-225-6581, FAX: 860-832-8707
WWW.STDGUN.COM

TABLE OF CONTENTS

Introduction.....	4
-------------------	---

DISCLAIMER, SAFETY AND HANDLING PROCEDURES

Disclaimer.....	5
Safe Handling Procedures.....	6
Safety Features.....	8
Function.....	8
Ammunition.....	8

LOADING, UNLOADING AND FIRING

Loading.....	10
Unloading.....	11
Firing.....	12

DISASSEMBLY AND REASSEMBLY

Basic Disassembly.....	13
Alternate Disassembly method.....	13
Basic Reassembly.....	14
Alternate Reassembly Method.....	14
Warranty Information.....	15

WARNING:

This firearm is a dangerous weapon, and is potentially LETHAL. Improper or careless handling could cause an accidental discharge, resulting in injury, death or property damage.

1911
.45 CALIBER

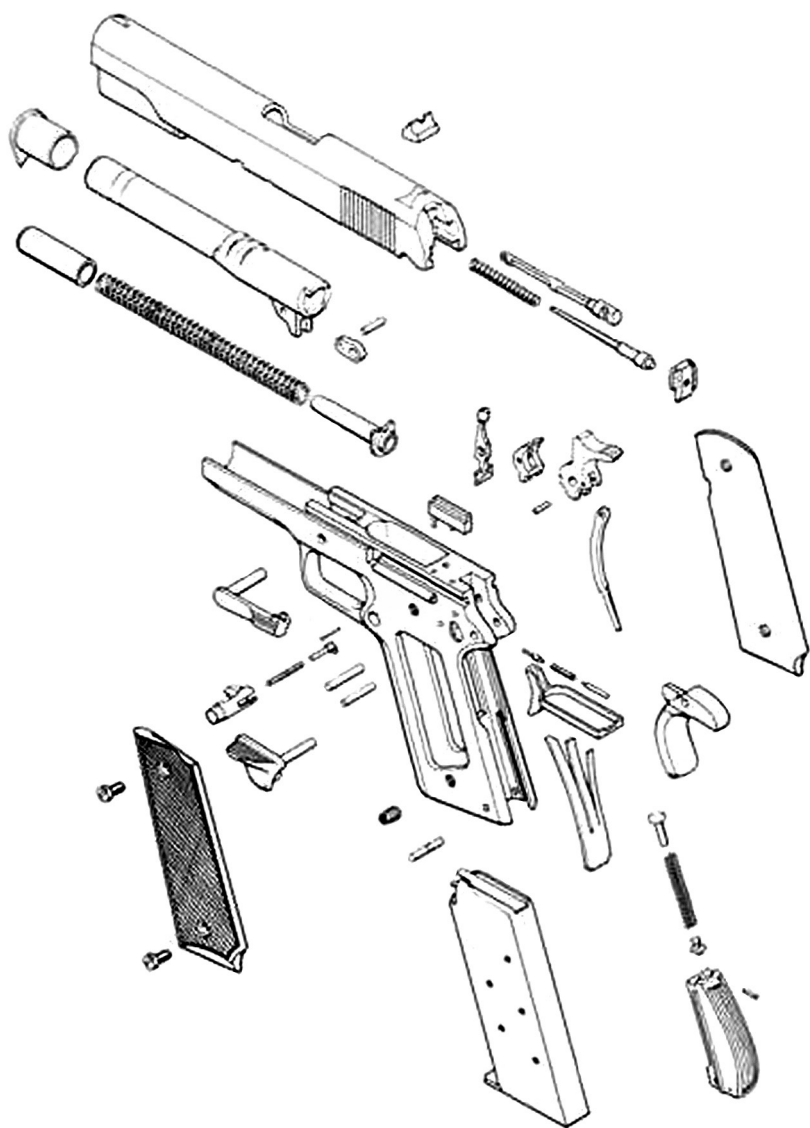

INTRODUCTION

This manual contains important information on safety, handling, lubrication, recommended ammunition and maintenance of your Standard Manufacturing 1911 firearm. This is a custom made firearm intended for experienced users. Your safety, as well as the safety of others depends on your constant use of safe firearm handling practices. Seek further assistance if you are unfamiliar with firearms, or are unsure of your ability to handle this firearm safely in any way. Safe handling courses are run by local gun clubs, approved NRA instructors and similar qualified organizations.

THE CONTENTS OF THIS MANUAL ARE NOT INTENDED TO BE A COMPREHENSIVE INSTRUCTIONAL MANUAL, AND SHOULD NOT BE DEEMED TO BE A COMPREHENSIVE INSTRUCTIONAL MANUAL ON THE SAFE HANDLING OF FIREARMS. IF YOU ARE UNSURE OF THE SAFE HANDLING PRACTICES TO BE UTILIZED IN THE OPERATION OF YOUR FIREARM, PLEASE SEEK THE ADVICE OF AN APPROVED NRA INSTRUCTOR OR OTHER SIMILARLY QUALIFIED INDIVIDUAL OR ENTITY.

FUNDAMENTALS OF 1911 HANDLING

The fundamentals are simple and easy. Like all fundamentals they are the source of most problems or issues that shooters experience.

1. Never slam the slide shut without a round being fed from the magazine. Slamming the slide shut on an unloaded gun is hard on the frame, barrel fit, and especially the hammer/sear engagement surfaces. Also never drop a round into the chamber and drop the slide on it. This springs the extractor out of position. Always feed rounds from a magazine.
2. Use high quality ammunition only such as Federal or Winchester.
3. Use high quality lubrication, and keep the firearm well lubricated and clean. Any high quality lubricant is acceptable.
4. Maintain a firm grip on the firearm and a locked wrist throughout the entire firing cycle. The 1911 is a recoil operated firearm. You should be gripping the firearm so tightly that slight imprint of the checkering (if any) is left on your hand. In order to cycle properly, the slide inertia needs to be absorbed solidly and a good grip will ensure this.
5. Make sure your recoil spring is correctly matched to the ammunition you are shooting. When you have the proper weight recoil spring for a particular load, ejected brass should land 8-12 feet away. If brass is falling within a few feet of you, your spring is too heavy for that load. If brass lands more than about 12 feet away, your spring is too light for that load. Either case leads to reduced reliability.

DISCLAIMER OF LIABILITY

STANDARD MANUFACTURING COMPANY INC. WILL NOT BE RESPONSIBLE FOR INJURY, DEATH, OR PROPERTY DAMAGE RESULTING FROM EITHER INTENTIONAL OR UNINTENTIONAL DISCHARGE OF THIS FIREARM. STANDARD MANUFACTURING COMPANY INC. WILL NOT BE RESPONSIBLE FOR THIS FIREARM'S FUNCTION WHEN USED FOR PURPOSES OR SUBJECTED TO TREATMENT FOR WHICH IT WAS NOT DESIGNED. STANDARD MANUFACTURING COMPANY INC. WILL NOT HONOR CLAIMS INVOLVING THIS FIREARM WHICH RESULT FROM CARELESS OR IMPROPER HANDLING, UNAPPROVED ALTERATION OR PARTS REPLACEMENT, CORROSION, NEGLIGENCE, THE USE OF INCORRECT CALIBER AMMUNITION, THE USE OF AMMUNITION OTHER THAN AN ORIGINAL HIGH GRADE COMMERCIALY MANUFACTURED AMMUNITION IN GOOD CONDITION, OR ANY COMBINATION THEREOF. STANDARD MANUFACTURING COMPANY INC. WILL NOT ACKNOWLEDGE CLAIMS INVOLVING THIS FIREARM FOR ANY REASON OR CAUSE WHEN SUCH CLAIMS ARE MADE BY THE SECOND OR SUBSEQUENT OWNER, OR ANY OTHER PERSON OR ORGANIZATION. BEFORE THIS FIREARM LEFT THE STANDARD MANUFACTURING COMPANY INC.; IT WAS CAREFULLY INSPECTED, TESTED AND PACKAGED. STANDARD MANUFACTURING COMPANY INC. CANNOT BE RESPONSIBLE FOR PRODUCT HANDLING AFTER IT LEAVES THE FACTORY, THEREFORE, PLEASE EXAMINE THE FIREARM CAREFULLY AT THE TIME OF PURCHASE TO INSURE THAT IT IS UNLOADED AND UNDAMAGED. THIS IS YOUR RESPONSIBILITY. THE DEALER CAN ASSIST YOU IN MAKING THIS EXAMINATION AND ANSWER ANY FURTHER QUESTIONS YOU MAYHAVE. IF YOU HAVE SPECIFIC QUESTIONS CONCERNING THE STATE OF THE FIREARM WHEN IT LEFT THE FACTORY, CALL STANDARD MANUFACTURING COMPANY INC. IMMEDIATELY. KEEP THIS INSTRUCTION MANUAL WITH YOUR FIREARM AT ALL TIMES. IT SHOULD BE TRANSFERRED WITH THE FIREARM IN CASE OF CHANGE OF OWNERSHIP. WE HOPE YOU ENJOY YOUR STANDARD MANUFACTURING 1911 PISTOL SAFELY. READ THIS MANUAL AND FOLLOW THE INSTRUCTIONS FOR YOUR SAFETY AND THE SAFETY OF OTHERS. STANDARD MANUFACTURING COMPANY INC. HEREBY DISCLAIMS ANY IMPLIED WARRANTIES, INCLUDING THE IMPLIED WARRANTY OF MERCHANTABILITY AND THE IMPLIED WARRANTY OF FITNESS FOR A PARTICULAR PURPOSE.

SAFE HANDLING PROCEDURES

1. **ALWAYS** keep the muzzle of the firearm pointed in a safe direction, and away from all humans, including yourself.
2. **ALWAYS** handle every firearm as if it were loaded.
3. **ALWAYS** check to be certain the firearm is unloaded - never take anyone's word for it.
4. **ALWAYS** keep and carry your firearm empty, with the hammer forward, except when you are ready to shoot.
5. **NEVER** place the hammer or allow the hammer to remain in the half-cock notch. This is not a safe carrying position and any effort to engage the hammer in the half-cock notch may result in the hammer perching on the lip of the half-cock notch. This is extremely dangerous. If the hammer is in this position it could fall forward and discharge the pistol, thereby risking injury, death or property damage.
6. **NEVER** drink alcoholic beverages or take drugs before, or during, any shooting activity. Your vision and judgment may be seriously impaired, making your firearm handling unsafe. If you are taking medication, seek a doctor's advice to assure that you are fit to shoot and handle firearms safely.
7. **ALWAYS** make sure your backstop is acceptable to stop and contain bullets before beginning target practice. This is to ensure that you do not hit anything outside the shooting area.
8. **ALWAYS** place a knowledgeable and responsible person in charge to maintain safety control when a group is firing on a range to reduce the chances of an accident. Always obey his or her commands.
9. **ALWAYS** wear and encourage others to wear ear protection when shooting, particularly on a range. Long-term, permanent hearing loss could be the result without hearing protection.
10. **ALWAYS** wear and encourage others to wear protective shooting glasses for the eyes.
11. **ALWAYS** make sure your firearm is clean. The barrel bore, chamber and action should be clean and free from obstructions. Clean a fouled pistol immediately so that it will function correctly and safely.
12. **ALWAYS** use only clean, dry, original, high grade commercially manufactured ammunition in good condition, appropriate to the caliber of your firearm.
13. **ALWAYS** carry your firearm open and empty while on a range until preparing to fire. Keep it pointed toward the backstop when loading, firing and unloading to eliminate the risk of injury, death or property damage.
14. **ALWAYS** keep yourself and others clear of the ejection port. Injuries can occur because spent cartridges are ejected with significant force, and they are hot. The ejection port must be unobstructed to insure safe ejection of live rounds. Never place your fingers in the ejection port, they could be burned by hot metal and/or powder, or injured by the slide moving forward.
15. **NEVER** put your finger inside the trigger guard or squeeze the trigger until you are aiming at a target and ready to shoot. This will prevent you from firing the pistol accidentally.
16. **ALWAYS** be sure of your target and the area behind it before you pull the trigger. A bullet can travel through or past your target up to 1 ½ miles before it stops!

17. **ALWAYS** keep your firearm pointed towards the target or a safe open area and wait at least 30 seconds if it fails to fire. If it is a hang fire (slow ignition) the round will fire within 30 seconds. Although it is very rare, you need to be aware of and prepared for this possibility. If the round does not fire, remove the magazine, eject the round and examine the primer. If the firing pin indent is light, off center, or nonexistent, have the firearm examined by a professional gunsmith. If the firing pin indent on the primer appears normal, assume faulty ammunition, separate the misfired round from other live ammunition and empty cases, reload and carry on firing. Dispose of misfired rounds in accordance with the ammunition manufacturer's instructions.
18. **NEVER** use your firearm if it fails to function properly. Never force a jammed action because a round may explode causing serious injury or death, and severe damage to your firearm. Before each shooting session, and before loading, give the firearm a quick safety check and visual inspection. If you find something that seems incorrect, do not load or fire. Ask a professional gunsmith for help, or call Standard Manufacturing Company Inc. for specific questions.
19. **NEVER** leave your firearm cocked. This position is extremely dangerous and the firearm could be easily accidentally discharged, causing injury, death or property damage.
20. **NEVER** shoot at a hard surface such as a rock or liquid surface such as water. The bullet could ricochet, hitting you, another person or unidentified object, causing injury, death or property damage.
21. **NEVER** fire your firearm near an animal that is not trained to accept the noise. It could startle the animal, causing injury or an accident.
22. **NEVER** engage in horseplay while holding a pistol. It could accidentally discharge, causing injury, death or property damage.
23. **NEVER** follow a companion with your firearm cocked ready to fire, out of its holster, or with the hammer in any position other than forward on an empty chamber. When hunting, hold your pistol so that you can always control the direction of the muzzle, in case of an accidental discharge.
24. **NEVER** leave a loaded firearm unattended. Someone may accidentally fire it, causing injury, death or property damage.
25. **ALWAYS** make sure the firearm is unloaded before cleaning, storing, or traveling. The magazine should be removed with the slide latched open before laying it down or handing it to another person, so that it cannot be fired accidentally.
26. **ALWAYS** store your firearm and ammunition in separate, locked containers, out of the reach and sight of children, or anyone else who should not handle the firearm.
27. **ALWAYS** instruct children to respect firearms. When teaching children to shoot, teach them to treat and use the pistol properly and responsibly first. Always supervise children closely and stress safety to prevent injury, death and property damage.

THE FOREGOING SAFE HANDLING PROCEDURES ARE NOT INTENDED TO CONSTITUTE A COMPREHENSIVE LIST OF ALL SAFE HANDLING PROCEDURES OF A FIREARM. IF YOU REMAIN CONCERNED REGARDING THE SAFE HANDLING OF YOUR FIREARM, PLEASE CONSULT AN APPROVED NRA INSTRUCTOR OR OTHER SIMILAR QUALIFIED INDIVIDUAL OR ORGANIZATION TO ASSIST YOU.

SAFETY FEATURES

This Standard Manufacturing firearm is equipped with several safety features which can minimize the danger of accidental discharge, if used properly.

NOTE: ALL safeties on this firearm are mechanical devices, which CAN FAIL. NEVER RELY ON A SAFETY DEVICE. Instead, depend upon safe firearm handling procedures, many of which are described in this manual.

GRIP SAFETY

The grip safety is located on the upper rear part of the receiver. The grip safety is automatically applied by a spring action to prevent rearward travel of the trigger unless the pistol grip is firmly and properly grasped. The front of the grip safety (inside the pistol frame) contacts the rear of the trigger to prevent its rearward movement. When the pistol grip is positively grasped, the grip safety is rotated out of contact with the rear of the trigger to allow trigger movement.

DISCONNECTOR

This safety device prevents a round being fired before it is in the chamber with the slide and barrel locked. When the slide is not fully forward the disconnector is depressed, its lower part disengages the sear, so that the hammer cannot be released if the trigger is squeezed. However, when the slide and barrel are locked, a spring pushes the disconnector up into a recess in the slide, this links trigger and sear so that the pistol can be fired by squeezing the trigger.

CAUTION: Never attempt to check or demonstrate the disconnector function with a loaded firearm. Pushing on the muzzle with your hand or any other portion of the body is extremely dangerous, and could result in accidental discharge causing injury, death or property damage.

FIRING PIN

The firing pin, which is shorter than it's housing, is held to the rear by a spring and cannot protrude through the face of the slide unless the force of a blow overcomes the spring pressure and the inertia of the pin. This will occur when the hammer falls normally or could occur by a blow on the muzzle or front of the firearm.

HALF COCK NOTCH ON HAMMER

The half cock notch is an automatically operating fail-safe device which will engage the sear in the unlikely event of a primary sear notch failure. This will prevent the hammer from falling fully forward unintentionally and will insure against uncontrolled automatic fire. It also prevents the hammer from striking the firing pin should your hand slip from the slide while cocking the pistol, provided the hammer is rotated past the half cock notch. The half cock notch is not meant to be engaged by hand.

CAUTION: Never place or allow the hammer to remain in the half cock notch position. This is not a safe carrying position. Any effort to engage the hammer in the half cock notch may result in the hammer perching on the lip of the half cock notch. This is extremely dangerous. If the hammer is in this condition it could fall forward and discharge the firearm, thereby risking injury, death or property damage.

SLIDE LOCK SAFETY OR THUMB SAFETY

The slide lock safety is located on the left of the pistol just below the back of the slide. With the hammer fully cocked and the slide lock safety applied, the upper part of the slide lock safety engages the slide lock notch to prevent rearward movement of the slide, while an internal cam surface engages the sear to prevent the hammer from moving forward when the trigger is squeezed. This safety device can only be applied when the slide is fully forward and the hammer is in a fully cocked position. To apply the slide lock safety, point the pistol in a safe direction. Do not touch the trigger and pull the slide fully to the rear and allow it to return gently forward, leaving the hammer in the fully cocked position. Press up on the slide lock safety until it fully engages the slide lock notch.

FUNCTION

Standard Manufacturing's 1911 pistols are ready to fire when a loaded magazine is inserted into the firearm, the slide is pulled back to cock the hammer, and released to travel forward and feed a round from the magazine into the chamber. Final forward slide movement locks the barrel and slide together and deactivates the disconnector. When the pistol stock (GRIP) is grasped, the grip safety is released so that the trigger may now be squeezed. When the trigger is squeezed, the sear disengages from the hammer which pivots forward under the force of the mainspring to strike the rear of the firing pin. The firing pin is driven forward to strike primer in the base of the cartridge. The energy imparted to the primer ignites it, the primer ignites the main powder charge which, in burning, rapidly generates extremely high gas pressure to drive the bullet down the barrel. Rifling grooves in the barrel impart a stabilizing spin to the bullet so that it will follow a more accurate path to the target. Force rearward on the slide breech face starts the slide and barrel on their rearward travel, however, the slide unlocks from the barrel only after gas pressure is reduced to a safe level. Rearward slide travel depresses the disconnector, carries the spent cartridge rearward on the extractor until the base of the cartridge is struck by the ejector to propel it through the ejection port. Slide movement continues under the momentum to fully cock the hammer. If the last round has been fired, the magazine follower will activate the slide stop to hold the slide to rear, but if a round remains in the magazine, the slide will move forward to feed and lock the next round in the chamber. To fire the next round, the trigger must be released and squeezed again.

AMMUNITION

We recommend high quality Federal or Winchester factory ammunition only. We do not recommend handloads or reloads of any kind. All ammunition used in this firearm must meet SAAMI specifications.

LOADING

TO LOAD THE MAGAZINE:

1. Use only high grade commercially manufactured ammunition in good condition.
2. With the open end uppermost, grasp the magazine, appropriate to caliber, in one hand. Place a round on the magazine follower with the base just forward of retaining lips. Press round down and back until base of round touches rear flat edge of magazine.
3. Place next round of top of previous round and press down and back. Repeat until magazine is fully loaded.

CAUTION: To minimize risk of unintentional discharge, load live ammunition into the pistol only when you are ready to shoot.

TO LOAD A PISTOL:

1. Remove the empty magazine from pistol by placing your hand under the magazine and push the magazine catch (located on left of pistol behind trigger guard) to release and eject the magazine from the magazine well.
2. Hold the firearm by the stock with one hand, keeping the other hand clear of the ejection port, and grasp the cocking serrations on both sides of the slide.
3. Pull the slide back slightly and look in the chamber to ensure it is empty.
4. Allow the slide to return forward. If the slide was fully to the rear, release the cocked hammer by squeezing the trigger after ensuring the chamber is empty.
5. Insert the loaded magazine into the magazine well with bullets pointing forward. Push the magazine fully home until the magazine catch is heard to click, locking it in place. It is important not to strike the base of the magazine to drive it home, just push it firmly into the pistol. Otherwise, you could damage the magazine and injure your hand.
6. When you are ready to shoot, grip the slide and pull it fully to the rear to cock the hammer. Release the slide to feed a round from the magazine into the chamber. The firearm is now loaded and ready to fire. Apply the slide lock safety to hold the slide forward and prevent the hammer from falling forward if the trigger is moved.

WARNING: When a round is in the chamber, the firearm may discharge accidentally if it is dropped or receives a blow. This can occur regardless of the position of the hammer or any of the various safety devices. Do not put a round in the chamber until the pistol is in your hand and you are ready to shoot, and clear the firearm immediately after shooting.

CAUTION: Never leave the firearm cocked ready to fire without the slide lock safety applied, as this is the fire condition and is extremely dangerous. The firearm could easily be accidentally discharged, causing injury, death or property damage.

NOTE: The safest way to carry your pistol is with an empty chamber and an empty magazine. However, if you wish to carry the pistol with a loaded magazine installed, keep the chamber empty, slide forward and hammer down.

UNLOADING

CAUTION: Always unload your firearm immediately after use and prior to cleaning and storage to minimize the risk of accidental discharge.

TO UNLOAD THE FIREARM:

1. Keep the pistol pointing in a safe direction. Do not touch the trigger and keep hands away from the muzzle and ejection port.
2. Place your hand under the magazine to prevent it from falling out and press the magazine catch to release and eject the magazine. If the slide is locked in the rearward position as a result of firing the last round from the magazine, the next steps do not apply.
3. With the thumb of your right hand, press the slide lock safety down out of engagement with the slide.
4. Using the slide cocking serrations, pull slide sharply rearward to extract and eject a round from the chamber.
5. Visually inspect the chamber to ensure it is empty and the magazine has been removed.
6. Release the slide forward onto the empty chamber by pulling the slide fully rearward and releasing or manually rotating the slide stop downward past the slide stop notch. Allow the slide to gently return forward on an empty chamber.

CAUTION: Repeatedly allowing the slide to slam closed on an empty chamber will cause premature wear and could damage the finely stoned surfaces of the sear which may ruin the trigger pull or cause an unsafe condition.

7. Squeeze the trigger to allow the hammer to fall forward.
8. Remove the remaining live rounds by sliding them forward out of the magazine.
9. Collect the live ammunition for safe storage and spent cartridge cases for disposal.

FIRING

Before firing your Standard Manufacturing handgun, practice your stance, aim, rhythm, and breathing for steady aim, with your firearm unloaded. Practice firing on a range before going hunting or using your pistol for any other type of shooting.

CAUTION: Always wear and encourage others to wear ear and eye protection when shooting.

1. Point muzzle in a safe direction
2. Load the firearm as previously described.
3. Grasp the firearm by the stock and with your index finger resting along the outside of the trigger guard and take aim. (Aim by aligning the target with the front and rear sights.)
4. Release the slide lock safety by pressing it down out of engagement with the slide lock notch.
5. Keeping steady aim, place your index finger on the trigger and press gently reward until the hammer falls. Don't jerk or slap the trigger as you will disturb your aim and spoil your accuracy. To fire the second and subsequent rounds, release the trigger and press again after every shot until you have completed firing.

NOTE: This is a semi-automatic firearm and is immediately loaded and ready to fire again after each shot, until the magazine is empty.

6. If all rounds have not been fired and you want to stop shooting, release the trigger, remove your index finger from the trigger, and engage the slide lock safety by pushing it up into the slide lock notch.
7. If the last round has been fired from the magazine, the slide will stay to the rear so the slide lock safety cannot be applied.

If your firearm fails to fire, keep it pointed toward the target or a safe open area and wait at least 30 seconds. If it is a hang fire (delayed ignition) the round will fire within 30 seconds. Although it is very rare, you need to be aware of and prepared for this possibility.

BASIC DISASSEMBLY

NOTE: Safety glasses are recommended, as there are several springs under tension. Remove magazine and unload gun as previously instructed in this manual. Visually confirm there are no live rounds in the chamber. It is preferable to have no live cartridges anywhere around you.

1. For pistols equipped with a two-piece guide rod, loosen the front end of the guide rod with a 5/32 hex head wrench, and remove from gun. If your gun is not equipped with a two-piece guide rod skip to step 2.
2. Pull back on the slide to align the slide stop catch with the takedown notch in the slide. Control the top of the gun while pushing the slide stop pin out as far as possible from right to left, then pull it out completely.
3. Wrap your hand around the top portion of the slide using your fingers to prevent the recoil spring from jumping out and carefully remove the slide from the frame.

CAUTION: the recoil spring is under pressure!

4. Set the frame aside and prepare to release the recoil spring and plug.
5. Carefully remove the recoil spring and recoil spring guide. The recoil spring plug can then be removed from the slide.
6. Turn the bushing fully counter-clockwise then slide barrel and bushing out the front of the slide. If necessary, use a bushing wrench.

ALTERNATE DISASSEMBLY METHOD

NOTE: Safety glasses are recommended, as there are several springs under tension. Remove magazine and unload gun as previously instructed in this manual. Visually confirm there are no live rounds in the chamber. It is preferable to have no live cartridges anywhere around you.

1. For pistols equipped with a two-piece guide rod, loosen the front end of the guide rod with a 5/32 hex head wrench, and remove from gun. If your gun is not equipped with a two-piece guide rod skip to step 2.
2. Using a bushing wrench, press the recoil spring plug down and twist the bushing clockwise. Remove the recoil spring plug.

CAUTION: the recoil spring is under pressure!

3. Pull back on the slide to align the slide stop catch with the takedown notch in the slide. Push the slide stop pin out as far as possible from right to left, then pull it out completely.
4. Pull the slide forward off the frame. Recoil spring and recoil spring guide can now be removed.
5. Turn the bushing fully counter-clockwise then slide barrel and bushing out the front of the slide. If necessary, use a bushing wrench.

BASIC REASSEMBLY

NOTE: Safety glasses are recommended, as there are several springs under tension. Remove magazine and unload gun as previously instructed in this manual. Visually confirm there are no live rounds in the chamber. It is preferable to have no live cartridges anywhere around you.

1. Insert barrel and bushing into the slide from the front. Make sure the link is pushed forward.
2. Turn bushing so it is lined up to accept the recoil spring plug. Make sure barrel is pushed all the way back so it engages the locking lugs.
3. Slide the recoil spring plug into position from the back. Make sure it lines up in the bushing.
4. Insert the recoil spring with the recoil spring guide attached into the rear of the plug. With one hand controlling the spring use your other hand to press the recoil spring guide into position ahead of the barrel link. Make sure the rounded cut out in the recoil spring guide is against the barrel, and the link is in the upward position.
5. Hold the spring firmly in place while assembling the slide onto the frame. Be careful not to allow the spring to jump out.
6. Insert the slide stop pin through the frame making sure it goes through the barrel link. It should rest just below the slide stop plunger.
7. Pull back on the slide to align the takedown notch in the slide. Control the top of the gun while pushing the slide stop up and into the frame. Be careful here to push up and in, it is easy to misapply the pressure and scratch an ugly radius into your frame or slide if you do not push directly in and slightly up to seat the slide stop in the slide stop window of the frame.

ALTERNATE REASSEMBLY METHOD

NOTE: Safety glasses are recommended, as there are several springs under tension. Remove magazine and unload gun as previously instructed in this manual. Visually confirm there are no live rounds in the chamber. It is preferable to have no live cartridges anywhere around you.

1. Insert barrel and bushing into the slide from the front. Make sure the link is pushed forward.
2. Twist the bushing fully clockwise.
3. Insert recoil spring with recoil spring guide through the back of the slide. Make sure the rounded cut in the recoil spring guide is against the barrel.
4. Install the slide on the frame.
5. Pull back on the slide to align the takedown notch in the slide.
6. Insert the slide stop pin through the frame making sure it goes through the barrel link. It should rest just below the slide stop plunger.
7. Push the slide stop up and into the frame. Be careful here to push up and in, it is easy to misapply the pressure and scratch an ugly radius into your frame if you do not push directly in and slightly up to seat the slide stop in the slide stop window of the frame.
8. Using your bushing wrench press the recoil spring plug into position. Once it is in position turn the bushing with your wrench counter clockwise until the plug can snap back into place.

LIMITED WARRANTY & SERVICE

This warranty is granted by Standard Mfg. This 1 year warranty is effective from the date of purchase and applies to the original owner of a Standard Mfg. firearm. Standard Mfg. firearms are warranted to be free from defects in material and workmanship. Any such defects of which Standard Mfg. receives written notice by the original owner, will be remedied by Standard Mfg. without charge within a reasonable time after such notification and delivery of the product as provided below.

If your Standard Mfg. firearm should ever require service or repair please perform the following to ensure fast and reliable service:

1. Include a copy of a bill of sale in the owner's name or a copy of ATF Form 4473 indicating date of purchase.
2. Include a written copy of the model and serial number of the firearm and a description of the difficulty experienced and service desired.
3. Include your name, desired return address, and a number where we can reach you.
4. Also include a written list of any accessories in your shipment – Standard Mfg. will not be responsible for any item that was not listed and confirmed by Standard Mfg.
5. Be sure the firearm is completely unloaded and the shipping container is free of ammunition. It is against postal and commercial regulations to ship ammunition.
6. Securely package your Standard Mfg. firearm and ship (transportation charges pre-paid) to:
Standard Mfg.
Service Department
100 Burritt Street
New Britain, CT 06053

It is recommended that shipments be insured by the owner, since Standard Mfg. will accept no responsibility for loss or damage in transit.

Transportation and insurance charges for return to owner will be paid by Standard Mfg. if the claim is covered by the warranty.

Under no circumstances shall Standard Mfg. be responsible for incidental or consequential damages with respect to economic loss or injury or property damage, whether as a result of breach of express or implied warranty, negligence or otherwise. Some states do not allow the exclusion or limitation of incidental or consequential damages, so the above limitation or exclusion may not apply to you.

